

destination:  
**Boston**



#### LOOKING FOR A GREAT DEAL IN BOSTON?

Visit [www.hiltonfamilyboston.com](http://www.hiltonfamilyboston.com) to view and book any of our fabulous offers and inclusive packages. For more information, call 1-800-222-TREE or contact the Doubletree Hotel Boston-Downtown directly at 617-956-7900.

#### HOLDING A MEETING? CONSIDER BOSTON!

View our unique meeting and banquet facilities and submit a Request for Proposal at [www.hiltonfamilyboston.com](http://www.hiltonfamilyboston.com). For more details or assistance, call our expert sales team at the Boston Regional Sales Center at 617-583-1100 or by email at [boston\\_rsc@hilton.com](mailto:boston_rsc@hilton.com).

#### Facilities & Services

- 267 guestrooms and suites including 11 executive level rooms offering upgraded hotel amenities
- Express check-in and check-out
- Complimentary access to the adjoining state-of-the-art YMCA health club with weight and aerobic rooms and Olympic-size pool
- Complimentary scheduled shuttle service to the nearby Bayside Expo Center
- Concierge
- Ample valet parking
- Complimentary 24-hour self-service Business Center
- In the heart of the Theatre District
- Non-smoking & accessible rooms available

#### Guest Rooms & Suites Amenities

- 25" Television with OnCommand Video featuring recently released movies
- Wireless and wired high-speed internet access and remote guestroom printing
- Sweet Dreams® by Doubletree sleep experience with plush-top mattress, luxurious linens, down comforter and jumbo pillows
- Mini bar and coffeemaker with complimentary coffee
- Two dual-line speaker phones with voice mail and data ports
- Large work desk with desk level outlets and ergonomic chair
- USA TODAY® delivered each weekday morning
- Iron and ironing board; hairdryer
- Individual climate control
- Electronic door locks

#### Dining & Entertainment

- Café – offering casual take-out serving fresh-baked goods, lite fare and gourmet coffee; open for breakfast & lunch
- Wisteria Restaurant and Bar – hip and casually elegant, featuring a full contemporary American menu at breakfast, lunch and dinner

#### Surrounding Attractions

- All of the renowned attractions of Boston and Cambridge are within easy access of our hotel by foot or the "T"
- Two blocks from the famous Boston Common and Public Gardens and across the street from the New England Medical Center, Chinatown and a variety of fine restaurants
- In the heart of the Theatre District
- TD Banknorth Garden (home of the Celtics & Bruins) and Fenway Park (home of the Red Sox)
- Cultural exhibits including the Museum of Fine Arts, the Computer Museum, Museum of Science, Children's Museum and New England Aquarium
- Walking distance to the Freedom Trail
- Historic landmarks: Faneuil Hall Market Place, North End, Paul Revere House, Old North Church, Old State House and the U.S.S. Constitution
- Minutes from Harvard Square, Harvard University, M.I.T., Boston University, Boston College and Colleges of the Fens area

#### Hilton HHonors®

- Hilton HHonors is the only guest reward program that lets you earn both hotel points and airline miles for the same stay at more than 2,800 hotels worldwide.
- With the Hilton HHonors Event Planner program, Event Planners can earn Points & Miles® for qualifying events. Ask your sales person for details.

[www.hiltonfamilyboston.com](http://www.hiltonfamilyboston.com)  
1-617-583-1100

**Doubletree Hotel Boston-Downtown**  
821 Washington Street  
Boston, Massachusetts 02111  
Tel: (617) 956-7900  
Fax: (617) 956-7901  
[www.hiltonfamilyboston.com/downtown](http://www.hiltonfamilyboston.com/downtown)

#### GDS CODES:

Amadeus: BOS821  
Apollo /Galileo: 4969  
Sabre: 52173  
WorldSpan: 4969

**Meeting & Banquet Facilities**



**MAIN LEVEL**

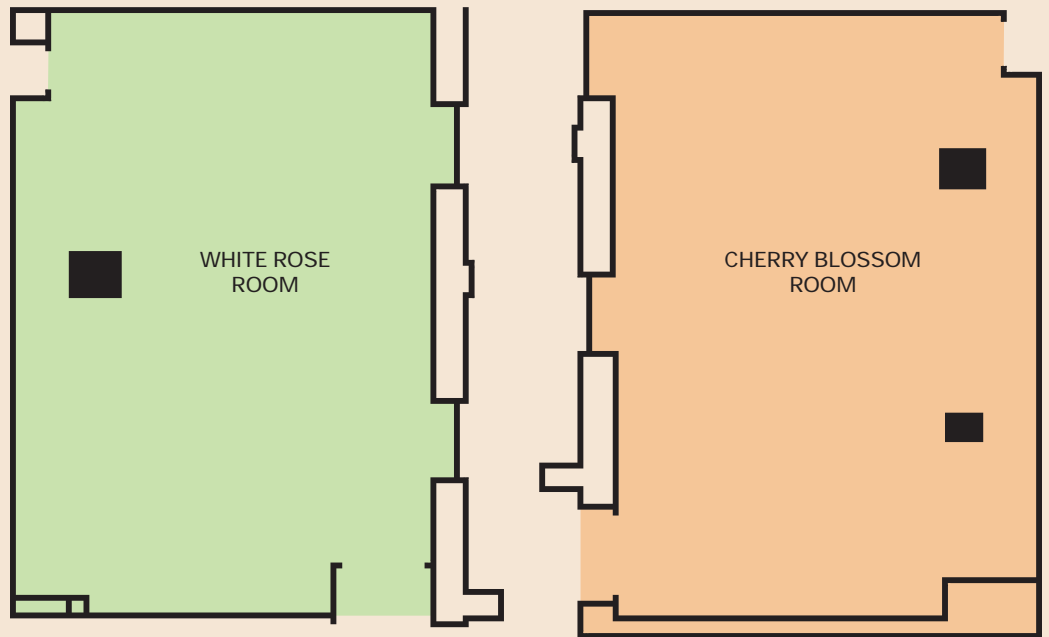

Main Level	Total Sq ft	LxWxH	Classroom	Theater	Banquet 10	Reception	Conference	U-Shape	H-Square
Cherry Blossom Room	925	26.5 x 35 x 12'	40	70	60	75	32	—	—
White Rose Room	867	24.75 x 35 x 12'	40	70	60	70	26	—	—
Wisteria Private Dining Room	220	22 x 10'	—	—	10	—	10	—	—
Courtyard (seasonal)	2,406	68.75 x 35'	—	—	200	300	—	—	—

Second Floor	Total Sq ft	LxWxH	Classroom	Theater	Banquet 10	Reception	Conference	U-Shape	H-Square
Pinetree Boardroom	126	10.5 x 12 x 10'	—	—	—	—	6	—	—

**Meeting and Banquet Facilities**

- 4,544 square feet of flexible meeting and banquet space accommodating up to 300 guests
- Wireless High-Speed Internet Access available in all public and meeting areas
- Video conferencing and state-of-the-art audio/visual
- Complete banquet and conference services staff and audio/visual team
- Professional meeting and catering specialists to oversee every detail



[www.hiltonfamilyboston.com](http://www.hiltonfamilyboston.com)  
1-617-583-1100

**Doubletree Hotel Boston-Downtown**  
821 Washington Street  
Boston, Massachusetts 02111  
Tel: (617) 956-7900  
Fax: (617) 956-7901  
[www.hiltonfamilyboston.com/downtown](http://www.hiltonfamilyboston.com/downtown)

**GDS CODES:**  
Amadeus: BOS821  
Apollo/Galileo: 4969  
Sabre: 52173  
WorldSpan: 4969

The Hilton HHonors Event Planner bonus is valid for new event bookings only and is awarded at the discretion of the hotel and may not be awarded on all group business events. Other restrictions may apply. For complete Event Planner Terms and Conditions, visit [www.hiltonhonors.com](http://www.hiltonhonors.com). \*Subject to state and local laws. Hilton HHonors® membership, earning of Points and Miles,® and redemption of points are subject to HHonors Terms and Conditions. 6/07 HSM/Swafford&Co35223 ©2007 Hilton Hospitality, Inc.